



CEILING AND PARTITION COMPONENTS

CAPCO: 90MIN FIRE RATED CEILING SYSTEM (OPINION)

PRIMARY GRID: T38/35G CONCEALED TEE CEILING SYSTEM

SECONDARY GRID: CAPCO FURRING CHANNEL

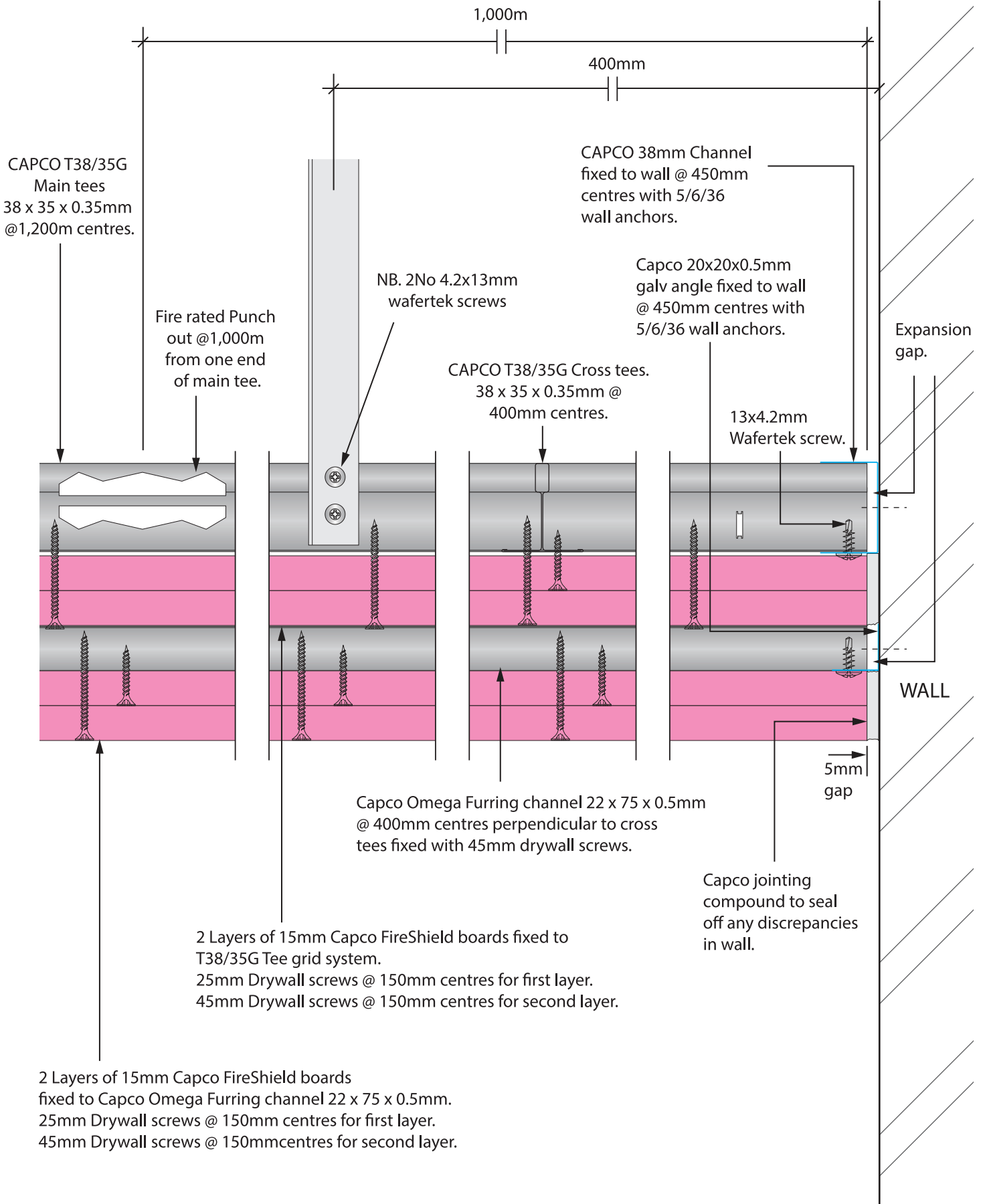

N.B. All FireShield gypsum board joints to be staggered.
Board joints to be fitted and flushed with Capco jointing compound.
Only final layer to be fitted with 50mm wide fibre-tape.



CAPCO: 90MIN FIRE RATED CEILING SYSTEM

PRIMARY GRID: T38/35G CONCEALED TEE CEILING SYSTEM
SECONDARY GRID: CAPCO FURRING CHANNEL

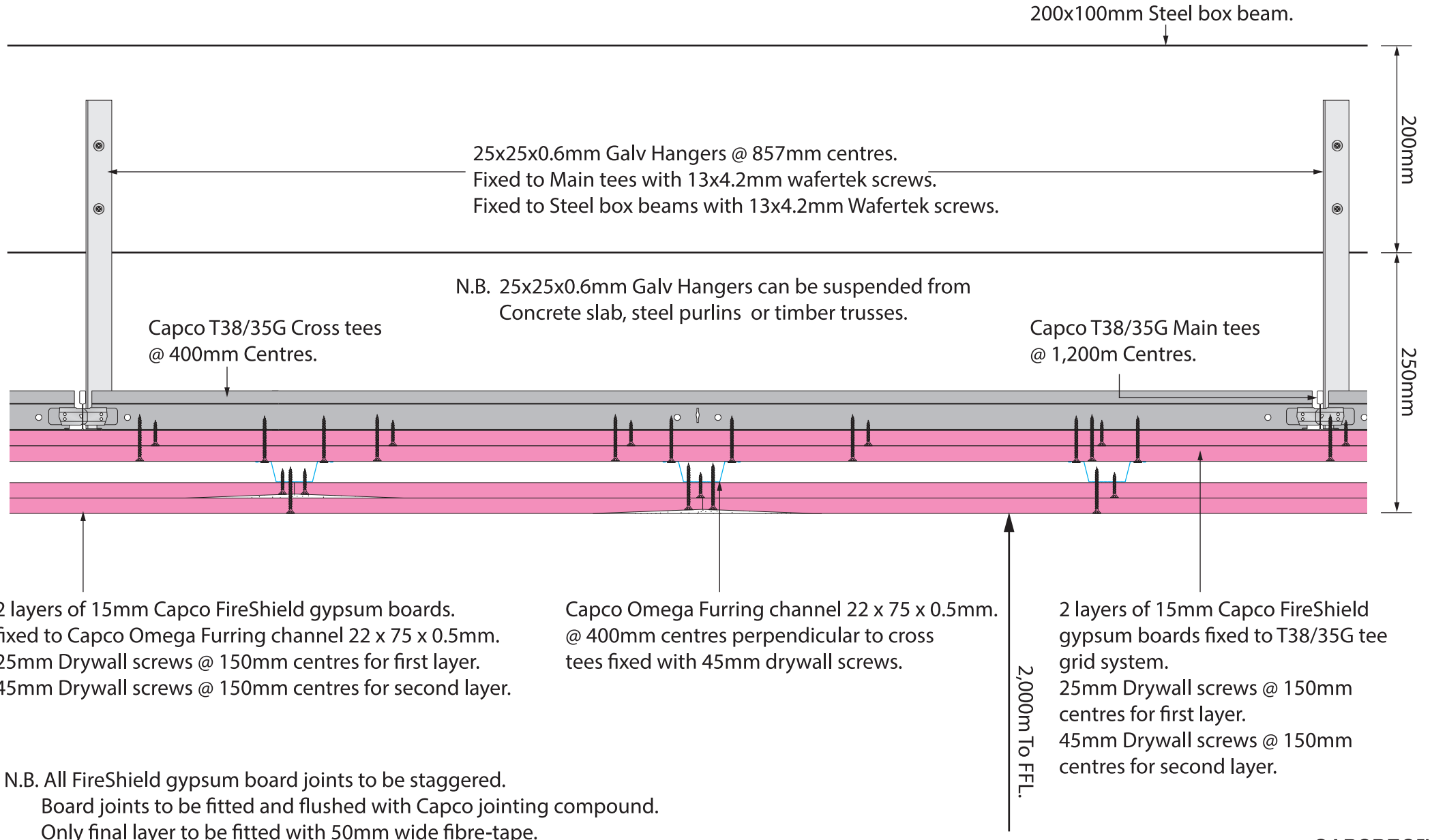

200x100mm Steel box beam.

200mm

250mm

25x25x0.6mm Galv Hangers @ 857mm centres.
Fixed to Main tees with 13x4.2mm wafertek screws.
Fixed to Steel box beams with 13x4.2mm Wafertek screws.

N.B. 25x25x0.6mm Galv Hangers can be suspended from
Concrete slab, steel purlins or timber trusses.

Capco T38/35G Cross tees
@ 400mm Centres.

Capco T38/35G Main tees
@ 1,200m Centres.

2 layers of 15mm Capco FireShield gypsum boards.
fixed to Capco Omega Furring channel 22 x 75 x 0.5mm.
25mm Drywall screws @ 150mm centres for first layer.
45mm Drywall screws @ 150mm centres for second layer.

Capco Omega Furring channel 22 x 75 x 0.5mm.
@ 400mm centres perpendicular to cross
tees fixed with 45mm drywall screws.

2 layers of 15mm Capco FireShield
gypsum boards fixed to T38/35G tee
grid system.
25mm Drywall screws @ 150mm
centres for first layer.
45mm Drywall screws @ 150mm
centres for second layer.

2,000mm To F.F.L.

N.B. All FireShield gypsum board joints to be staggered.
Board joints to be fitted and flushed with Capco jointing compound.
Only final layer to be fitted with 50mm wide fibre-tape.

CAPCO: 90MIN FIRE RATED CEILING SYSTEM

PRIMARY GRID: T38/35G CONCEALED TEE CEILING SYSTEM
SECONDARY GRID: CAPCO FURRING CHANNEL

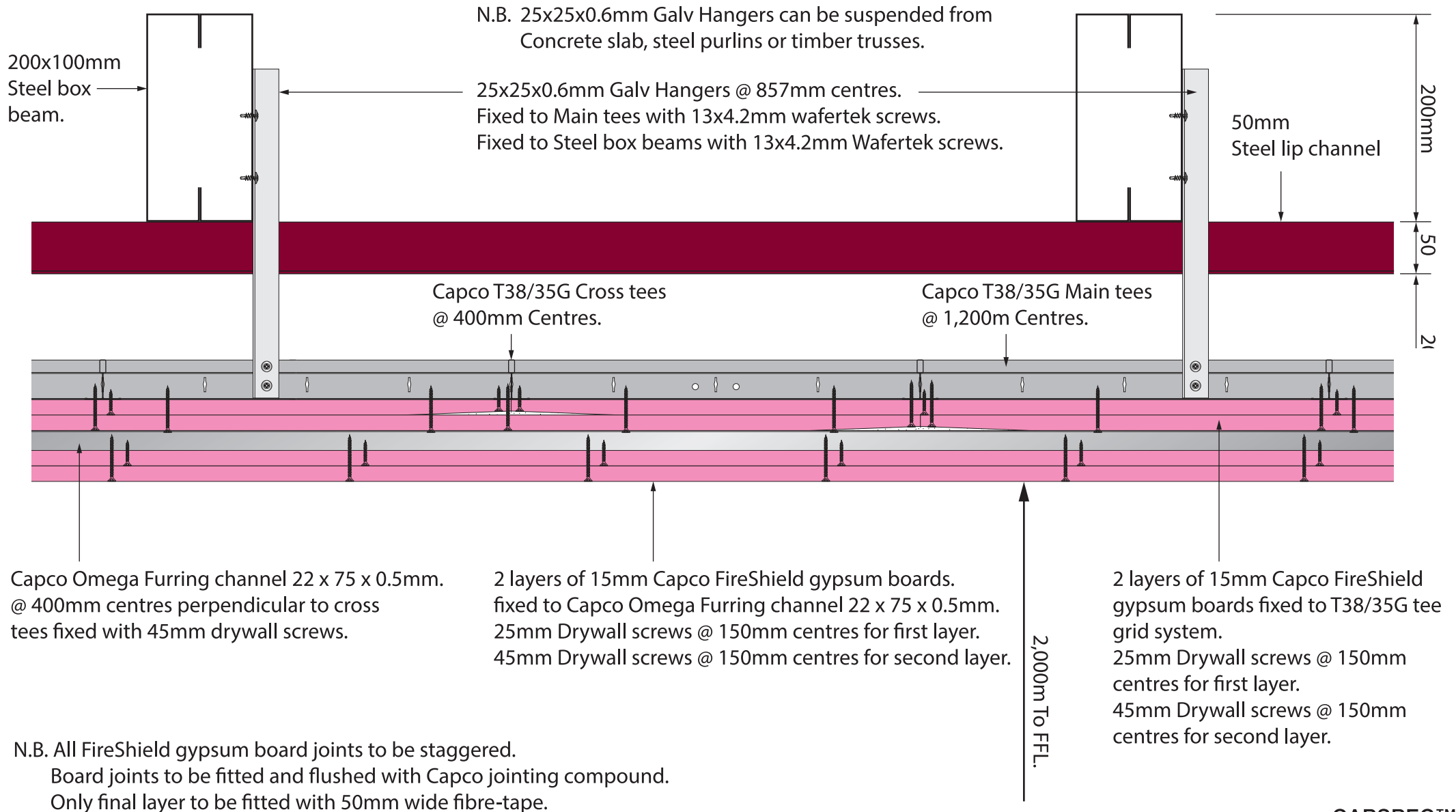



CEILING AND PARTITION COMPONENTS

CAPCO: 90MIN FIRE RATED CEILING SYSTEM

PRIMARY GRID: T38/35G CONCEALED TEE CEILING SYSTEM
SECONDARY GRID: CAPCO FURRING CHANNEL

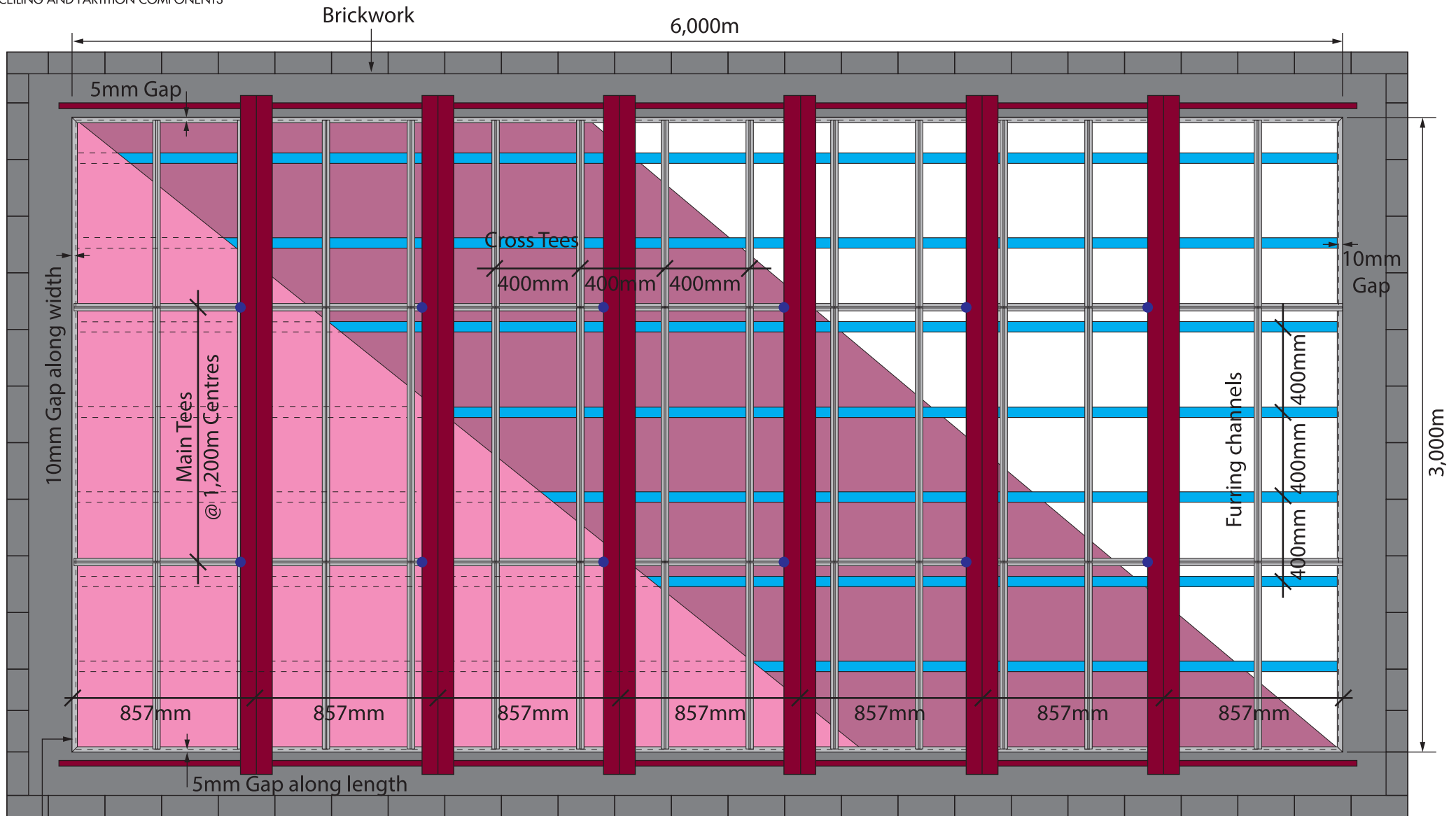

CAPCO 38mm Channel fixed to wall @ 450mm centres with 5/6/36 wall anchors.

● 25x25x0.6mm Galv Hangers fixed to main tees @ 857mm centres

■ 2 layers of 15mm Capco FireShield gypsum boards fixed to T38/35 Tee Grid Ceiling System.

■ 2 layers of 15mm Capco FireShield gypsum boards fixed to Capco Furring channel 19 x 49 x 0.4mm.