

SHERA EXTERNAL FIBRE CEMENT BOARDS CONTROL JOINT FINISH (IF WALL IS LONGER THAN 6M)

1. Control Joints are necessary at every continuous length of 6,000m horizontally and vertically.
2. All horizontal and vertical control joints must meet with the frame. Frames required on each side scaled 10mm apart.
3. SHERA boards should be primed on all 6 sides before application.
4. All joints to be staggered.

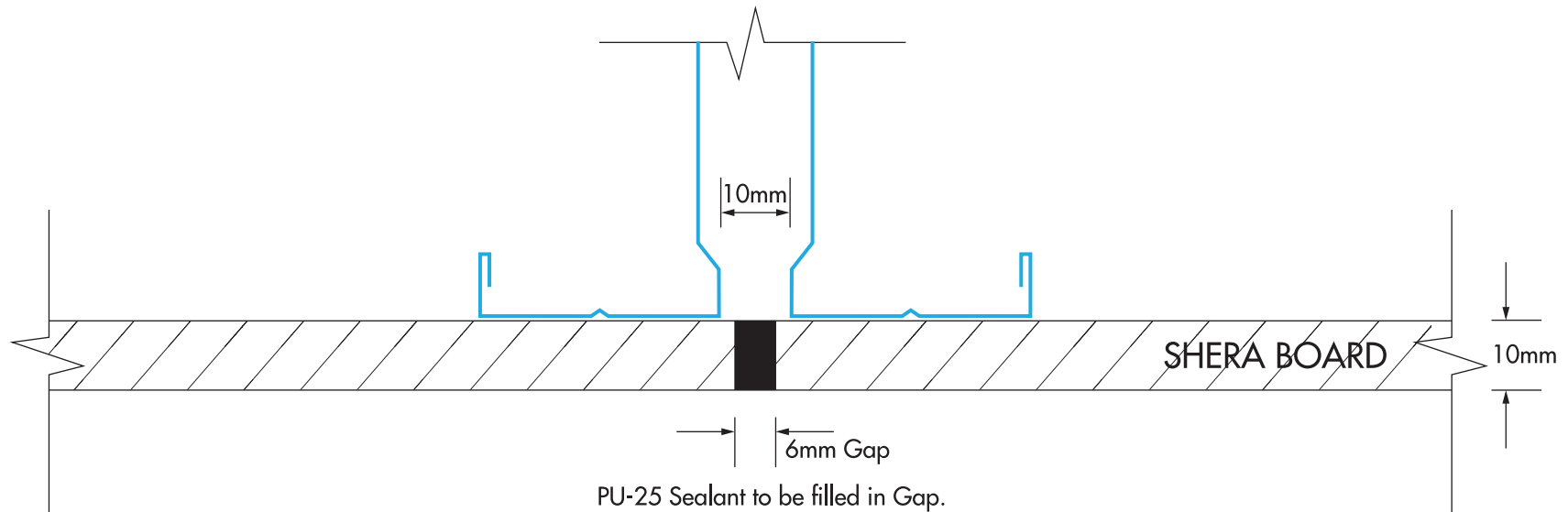

Steps (As shown on Drawing):

If the wall is longer than 6,000m , Joint Control is a must. A 6mm gap filled with PU-25 Sealant is required.

This means that every 5 pieces (1200m x 5 pieces = 6,000m) of board, require a control joint.

The edge at control joints should be square cut and filled with PU-25 Sealant (In case you have a tapered edge board, you may use an angle grinder to cut the tapered edge off. Double frame is applied at control joints).

Note:

If the wall is less than 6,000m , you can control joint at column. The gap must be 1% of the wall length.

(For example, if the wall is 3,000m then the gap should be 3mm)