

# HI-WALL SYSTEM: 8M

**BETA**  
DRYWALL SYSTEM

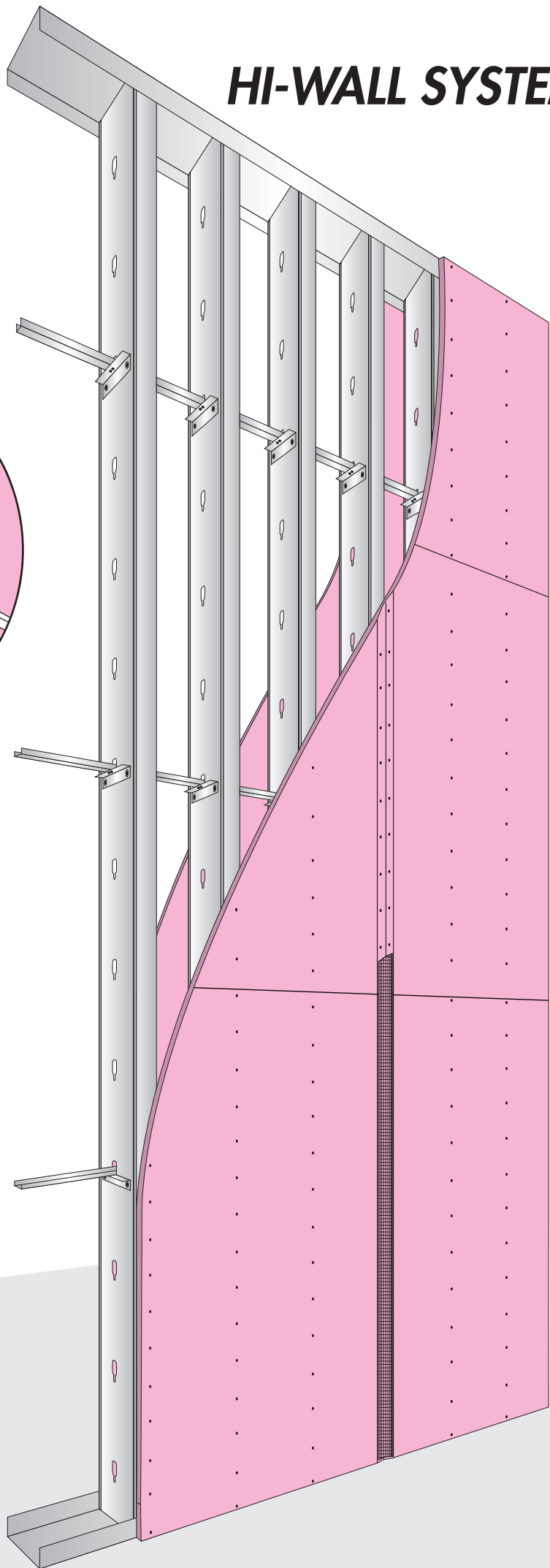

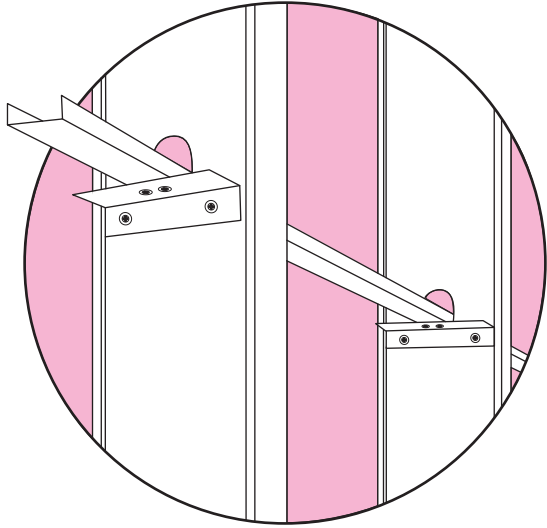

# **HI-WALL SYSTEM: 8M HIGH**

## **152mm Steel Stud & 154mm Steel Track**

### **CAPCO HI-WALL SYSTEM: 8M HIGH**

**Vertical Studs:** 152 x 35 x 6.5 x 0.8mm at 400mm centres

**Top & Bottom Tracks:** 154 x 50 x 0.8mm

**Horizontal Noggings:** 38 x 12 x 1.00mm at 1.800m centres.

**Nogging fixing:** 130 x 25 x 25 x 0.8mm Galvanised Angles fixed to studs with 4.2 x 3mm Wafertek screws.

**Boarding:** 15mm tapered edge "FireShield" gypsum board fixed to each side of partition. Staggered joints.



154mm Deep Steel Track

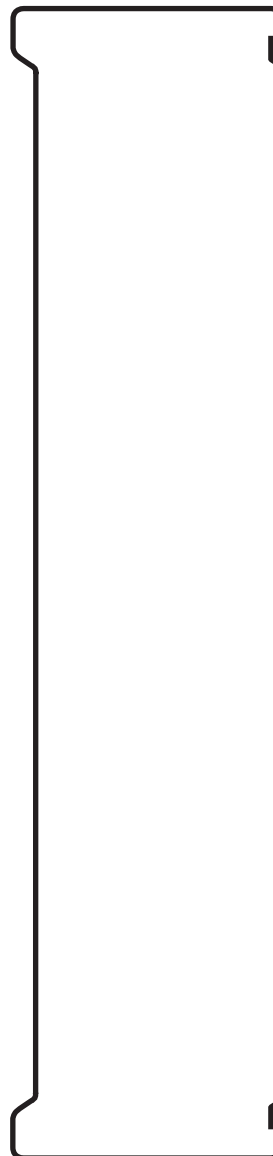

152mm Steel Stud