

BETA

DRYWALL SYSTEM

HI-WALL SYSTEM: 10M

120MIN FIRE RATING

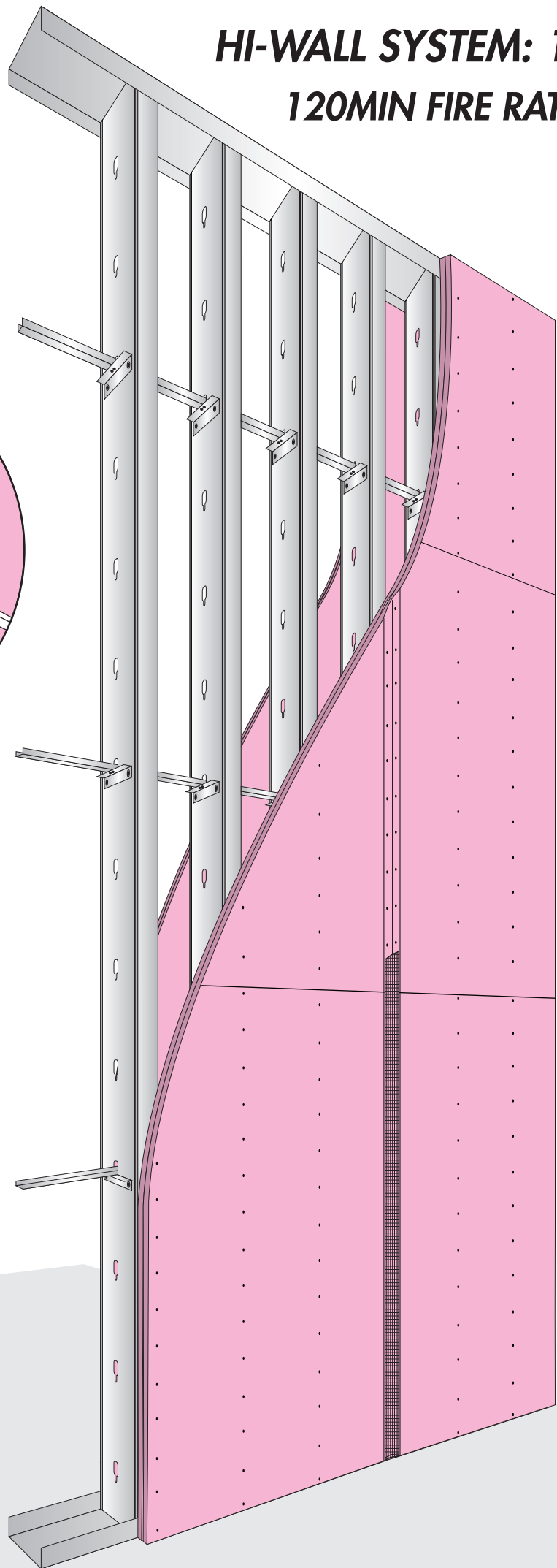
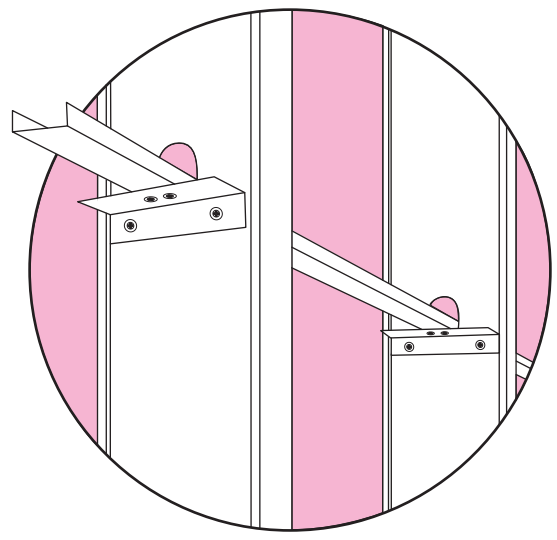

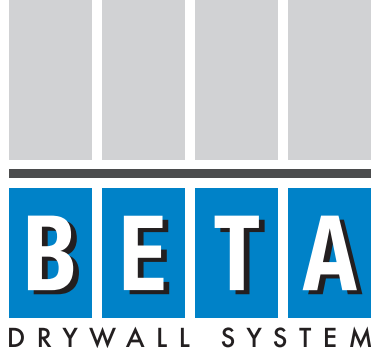

HI-WALL SYSTEM: 10M HIGH

152mm Steel Stud & 154mm Steel Track

CAPCO HI-WALL SYSTEM: 10M HIGH

Vertical Studs: 152 x 35 x 6.5 x 0.8mm at 400mm centres

Top & Bottom Tracks: 154 x 50 x 0.8mm

Horizontal Noggings: 38 x 12 x 1.00mm at 1.800m centres.

Nogging fixing: 130 x 25 x 25 x 0.6mm Galvanised Angles fixed to studs with 4.2 x 3mm Wafertek screws.

Boarding: 2 Layers of 15mm tapered edge "FireShield" gypsum boards fixed to each side of partition.

All joints to be staggered.

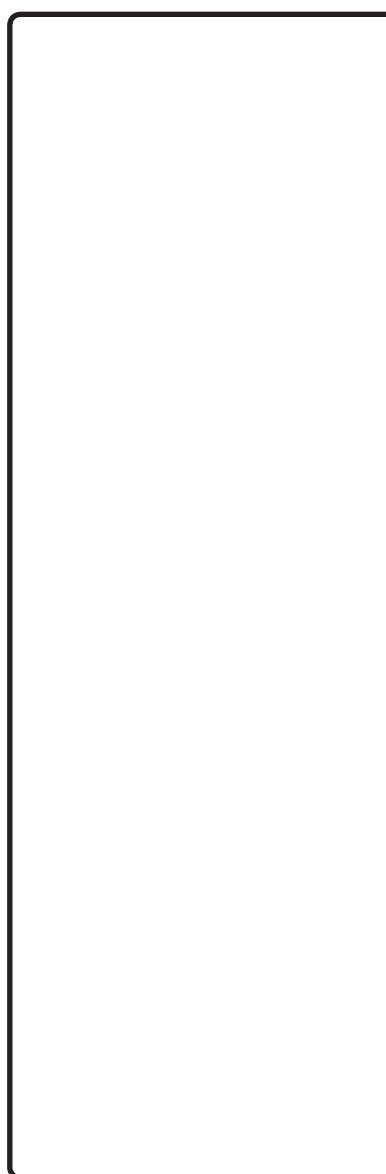

154mm Deep Steel Track

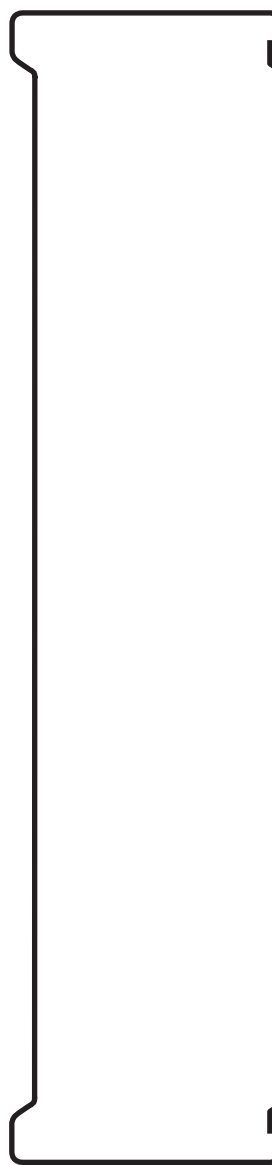

152mm Steel Stud